

# RACO® RETRO-RING™

## Life Safety Appliances

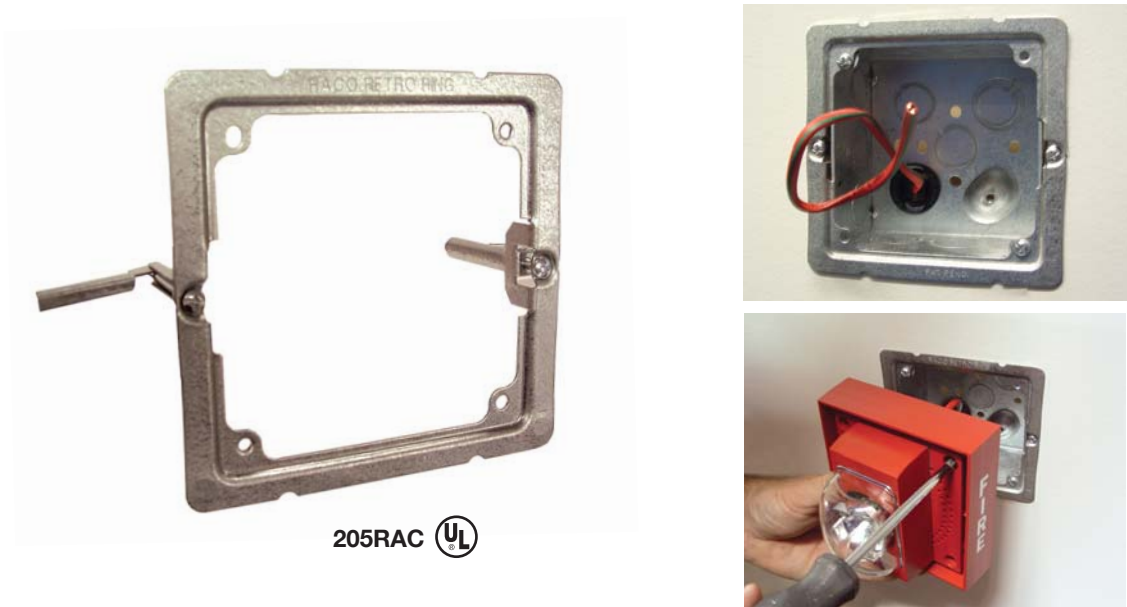

### Application

- RACO RETRO-RING is used to position a 4" square steel junction box in a sheet rock covered wall cavity.
- RACO 205RAC is used in old work, life safety appliance installations

### Features

- Allows 4" square box to be quickly and easily mounted in old work application
- Accommodates any depth, 4" square box
- Works in 3/8" to 1-1/2" thick, wall or ceiling applications
- Small footprint is easily covered by most popular life safety devices (any appliance greater than 4-13/32" W x 4-3/4" H)
- Steel old work wings allow for secure mounting of box and device to wall
- Includes one wall template per carton for easy trace-&-cut-out
- Made from durable, .039" thick galvanized steel

| RETRO-RING For Life Safety Appliances, 4" Square Box Mounting |   |           |
|---|---|-----------|
| CATALOG NUMBER  | DESCRIPTION                               | STD. PKG. |
| 205RAC  | RETRO-RING for Life Safety Device Support | 20        |

Patent Pending

# RACO® RETRO-RING™

## One or Two-Devices, Power/Data

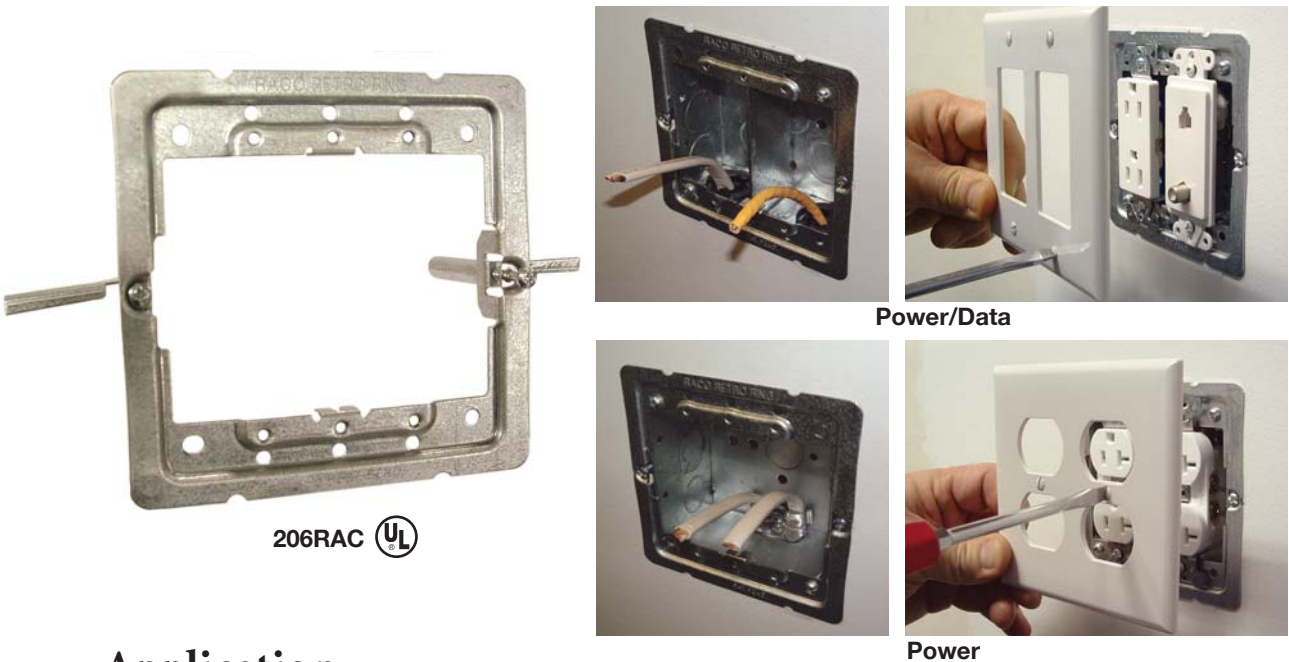

### Application

- RACO RETRO-RING is used to position a 4" square steel junction box in a sheet rock covered wall cavity. RACO 206RAC is used in old work installations where one or two devices are required

### Features

- Allows 4" square box to be quickly and easily mounted in old work application
- Accommodates any depth, 4" square box
- One or two devices mount directly to RETRO-RING
- Works in 3/8" to 1-1/2" thick, wall or ceiling applications
- Small footprint is easily covered by wall plate (any wall plate greater than 4-13/32" W x 4-3/4" H)
- Steel old work wings allow for secure mounting of box and devices to wall
- Includes one wall template per carton for easy trace-&-cut-out
- Design allows for installation of steel low voltage partition for power/data applications
- Made from durable, .039" thick galvanized steel
- Can be used to mount low voltage devices without a box

| RETRO-RING For Power/Data Device(s), 4" Square Box Mounting |   |           |
|---|---|-----------|
| CATALOG NUMBER  | DESCRIPTION   | STD. PKG. |
| 206RAC  | RETRO-RING for One or Two Device Applications         | 20        |
| 706RAC  | Box Partition for RETRO-RING & 1-1/2" Deep 4" Sq. Box | 25        |
| 707RAC  | Box Partition for RETRO-RING & 2-1/8" Deep 4" Sq. Box | 25        |

Patent Pending