

NOTES:

1. NEMA 1 INDOOR STITCH WELDED CONSTRUCTION
2. HINGED FRONT COVER WITH WRAP AROUND LIP
3. 3 POLE UL LISTED FUSE HOLDER
4. RED POWDER COAT FINISH
5. CAM 45 KEYED DOOR LOCK
6. FACTORY INSTALLED NEUTRAL BARS AVAILABLE

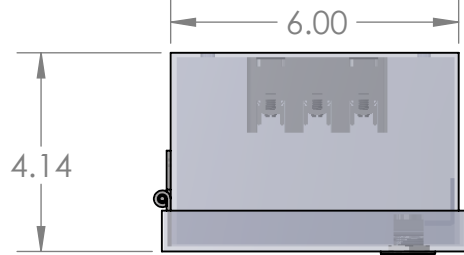

TOP VIEW

E167302



CABINETS AND CUT OUT BOXES

LOT NO. XXXXXX

NAV-TECH INC.

HAUPPAUGE, NEW YORK

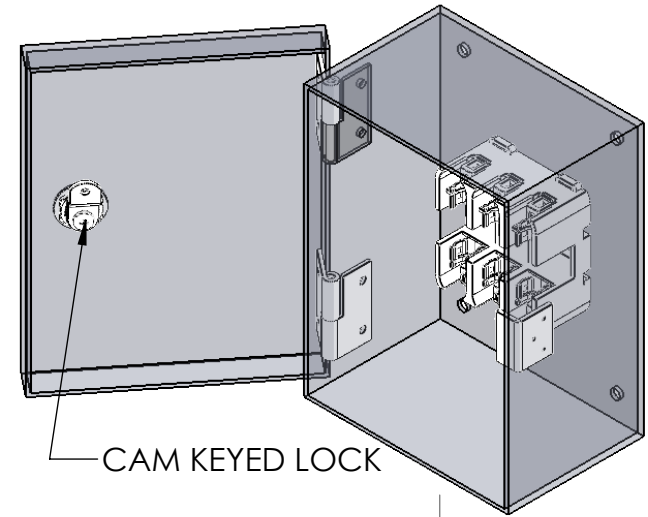

CAM KEYED LOCK

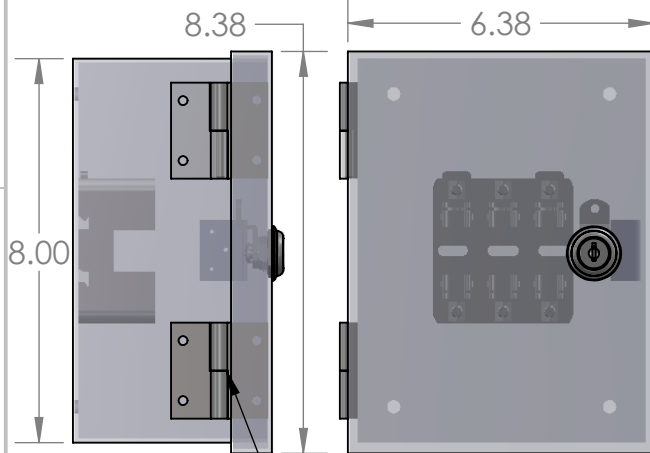

LEFT SIDE

CLOSED FRONT VIEW

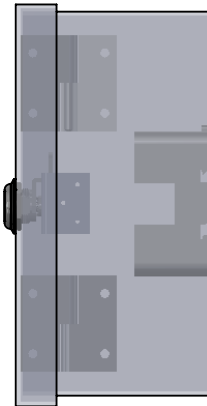

RIGHT SIDE

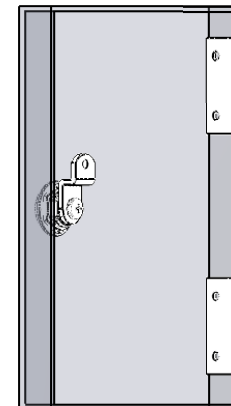

4X 0.25" MOUNTING HOLES

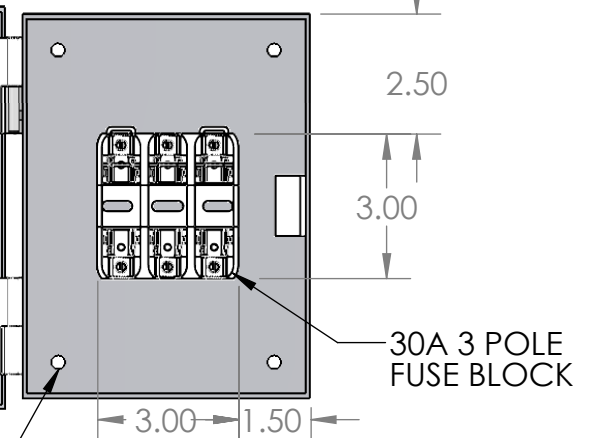

OPEN FRONT VIEW

30A 3 POLE FUSE BLOCK

HINGED DOOR

	NAME	DATE
DRAWN BY	J. Pincus	7/24/2023
APPROVED BY		

**PROPRIETARY AND CONFIDENTIAL**  
THE INFORMATION CONTAINED IN THIS DRAWING IS THE SOLE PROPERTY OF Nav-Tech Inc. ANY REPRODUCTION IN PART OR AS A WHOLE WITHOUT THE WRITTEN PERMISSION OF Nav-Tech Inc. IS PROHIBITED.



155 MARCUS BLVD  
HAUPPAUGE, NEW YORK 11788  
PH: (718) 257-2111 FAX: (718) 257-2626

**UNLESS OTHERWISE SPECIFIED:**  
ALL DIMENSIONS ARE NOMINAL UNLESS EXPLICITLY SPECIFIED OTHERWISE

MATL: 12 GA GALV  
FINISH: POWDER COATED RED  
WEIGHT:

UNLESS OTHERWISE SPECIFIED

1. REMOVE ALL BURRS AND BREAK ALL SHARP EDGES .015 X 45° OR .015R
2. DIMENSIONAL LIMITS APPLY AFTER PLATING

3. 125/ MACHINED SURFACES EXCEPT AS NOTED

DRAWING TITLE:

8" X 6" X 4" FIRE ALARM CUT OUT BOX

PART #:

FAB 864

DESCRIPTION:

NEMA 1 8" X 6" X 4" FIRE ALARM CUT OUT BOX WITH 30 AMP 3 POLE FUSE BLOCK AND LOCKING HINGE COVER

**DO NOT SCALE DRAWING**

SCALE: 1:4

SIZE

A

SHEET

1 OF 1

REV.

0