

EZPANHE2X2-23N/D10 RCL



2' x 2' EZPANHE edgelit LED panel lights provide smooth and uniform light edge-to-edge for a clean, modern look. Install in drop ceilings or use optional surface, pendant or recessed (dry wall) mounting kits.

Color: White

Weight: 7.1 lbs

Project:

Type:

Prepared By:

Date:

Driver Info

Type	Constant Current
120V	0.19A
208V	0.11A
240V	0.1A
277V	0.08A
Input Watts	24.40W

LED Info

Watts	23W
Color Temp	4000K (Neutral)
Color Accuracy	81 CRI
L70 Lifespan	100,000
Lumens	3,227
Efficacy	132.3 LPW

Technical Specifications

Listings

cUL Listed:

Suitable for damp locations

IESNA LM-79 & IESNA LM-80 Testing:

RC LED luminaires and LED components have been tested by an independent laboratory in accordance with IESNA LM-79 and LM-80

DLC Listed:

This product is listed by Design Lights Consortium (DLC) as an ultra-efficient premium product that qualifies for the highest tier of rebates from DLC Member Utilities. DLC Product Code: PLHEU2U29GA0

Electrical

Driver:

Constant Current, Class 2, 120-277V, 50/60 Hz, 120V: 0.1A, 208V: 0.06A, 240V: 0.05A, 277V: 0.04A

THD:

9.2% at 120V, 8.9% at 277V

Power Factor:

99.4% at 120V, 94.8% at 277V

Note:

All values are typical (tolerance +/- 10%)

LED Characteristics

Lifespan:

100,000-hour LED lifespan based on IES LM-80 results and TM-21 calculations

LEDs:

Long-life, high-efficacy, surface-mount LEDs; binned and mixed for uniform light output and color

Color Uniformity:

RC's range of Correlated Color Temperature follows the guidelines of the American National Standard for Specifications for the Chromaticity of Solid State Lighting (SSL) Products, ANSI C78.377-2017.

Color Stability:

LED color temperature is warranted to shift no more than 200K in color temperature over a 5-year period

Construction

Maximum Ambient Temperature:

Suitable for use in -30°C (-22°F) to 50°C(122°F)

IC Rated:

Suitable for insulated ceilings

Lens:

Frosted Polystyrene

Mounting:

Recessed ceiling

Housing:

Lightweight aluminum housing, steel pan and junction box

Installation:

Standard integral T-bar clips secure the fixture to T-bars and prevent T-system separation

Finish:

Formulated for high durability and long-lasting color

Green Technology:

Mercury and UV free. RoHS-compliant components.

Other

Warranty:

RC warrants that our LED products will be free from defects in materials and workmanship for a period of five (5) years from the date of delivery to the end user, including coverage of light output, color stability, driver performance and fixture finish. RC's warranty is subject to all terms and conditions found at rclighting.ca/warranty.

Technical Specifications (continued)

Other _____ :

Equivalency :

Equivalent to (4)F32T8 or (4)F28T5

Dimensions

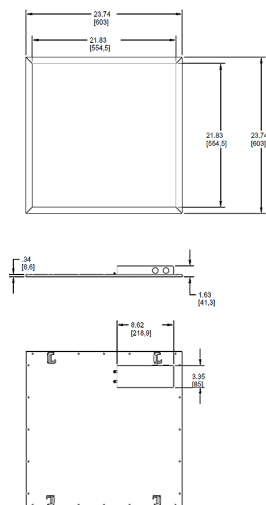

Features

Best in class efficacy

Innovative use of edge lit technology for glare-free lighting

0-10V dimmable driver, standard

Ordering Matrix

Family	Size	Wattage	Color Temp	Driver	Options
EZPANHE	2X2	23	N	/D10	
	2X2 = 2' x 2'	12 = 12W 23 = 23W 30 = 30W	Blank = 5000K (Cool) N = 4000K (Neutral) YN = 3500K (Warm Neutral) Y = 3000K (Warm)	/D10 = 0-10V Dimming	Blank = No Option /LC = Lightcloud® Controller /E2 = Battery 120-277V