



FEATURES & SPECIFICATIONS

INTENDED USE — The PS30250 dual-voltage (120V or 277V) emergency LED driver is designed to provide a minimum of 90 minutes of illumination for LED luminaires during the loss of normal AC power. It is UL classified for field installation in specified luminaires and UL recognized for factory installation, providing 30-watts maximum output power, constant current, with two options for loads up to 100 VDC or 250VDC. Option will be configured during installation.

CONSTRUCTION — 20-gauge, black steel enclosure.

PERFORMANCE — When normal AC power fails, the PS30250 immediately drives the LED load at a reduced light output for a minimum of 90 minutes. When AC power is present, the emergency LED driver operates in various charging modes to ensure the sealed, maintenance-free, high-temperature nickel-cadmium batteries are fully recharged within 48 hours after a discharge and remains fully charged until the next loss of AC power. The pilot light/test switch provides visual and manual means of monitoring the system operation.

ELECTRICAL

Constant current series resistor-type charger, provides high efficiency and reliable operation.

High efficiency push-pull inverter is the most effective method of converting power. It provides maximum light output, battery life and reliability.

AC/LVD reset allows battery connection before AC power is applied and prevents battery damage from deep discharge.

Dual-volt input capability – 120V or 277V

Output — 100 mA for voltage up to 250 VDC

250 mA for voltage up to 100 VDC

Maximum Output Power – 30 watts

Maximum AC input (120V) – 92 mA, 9.6 Watts

Maximum AC input (277V) – 41 mA, 10.2 Watts

BATTERY — Sealed, maintenance-free, high temperature nickel cadmium battery. Ensures long life over wide temperature ranges. Battery automatically recharges after any discharge.

External battery connectors allow battery pack to be disabled for maintenance and installation.

Pilot light and test switch provide visual and manual means of monitoring system operation. Two 1/2" holes are required to permit mounting of pilot light/test switch in fixture housing.

INSTALLATION — Mounts concealed within plenum or on top of fixture housing for improved aesthetics and protection from vandalism. Wiring protected by 18" flexible conduit.

Emergency Driver may be remote mounted up to 50 feet from fixture, or half the distance recommended by the driver manufacturer, whichever is less.

Test switch may be remote mounted up to eight feet from fixture. Order ELA RTS2 accessory.

LISTINGS — UL recognized. Meets UL 924, NFPA 101 (current Life Safety Code), NEC and OSHA illumination standards.

Standard unit is UL recognized for installation in damp or wet location sealed and gasketed listed luminaires.

Not suitable for mounting outside the luminaire in a wet location application.

Ambient temp ratings 0°C to 50°C (32°F to 122°F).

UL classified for field installation in the Acuity Brands IBG, IBL and IBH fixture families.

WARRANTY — 5-year limited warranty. Complete warranty terms located at:

www.acuitybrands.com/CustomerResources/Terms_and_conditions.aspx

Note: Actual performance may differ as a result of end-user environment and application. Specifications subject to change without notice.

Catalog
Number

Notes

Type

PS30250

LED Emergency Battery Pack

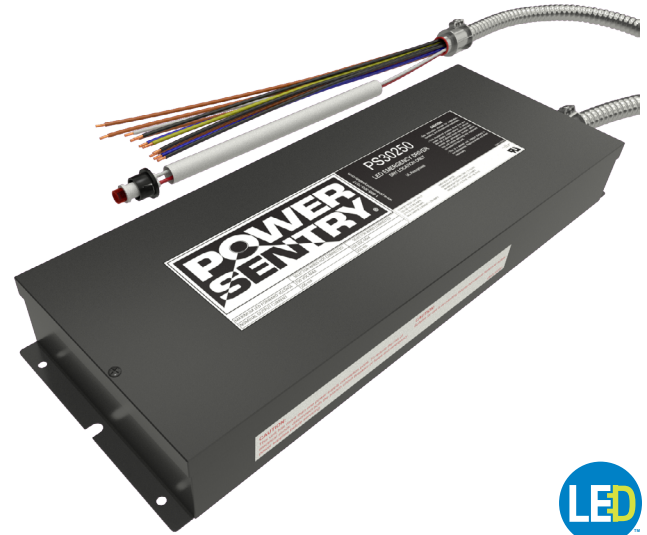

MOUNTING

All dimensions are in inches.

Enclosure Length: 15 3/8 inches

Shipping weight: 10.3 lb (4.7 kg)

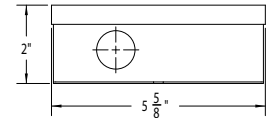

How to Calculate Delivered Lumens in Emergency Mode

Use the formula below to determine the delivered lumens in emergency mode

Delivered Lumens = 1.25 x P x LPW

P = Output power of emergency driver. P = 30W for PS30250

LPW = Lumen per watt rating of the luminaire. This information is available on the ABL luminaire spec sheet.

The LPW rating is also available at Designlight Consortium.

ORDERING INFORMATION

Lead times will vary depending on options selected. Consult with your sales representative.

Example: PS30250

PS30250

Series

PS30250 Power Sentry 30W Max Output Wattage 100 or 250VDC Max Output Voltage¹

Accessories²: Order as separate catalog number.

ELA RTS2 Remote test switch; mounts up to 25' away from fixture

Notes

- 1 100VDC/250VDC option set during installation via violet wire connection. See installation instructions for more details.
- 2 See accessories specification sheets for details on other compatible devices [ELA-RTS-TSPLP-PSTS-PSPR5B](#).

SPECIFICATIONS

KEY FEATURES

- Test Switch and Pilot Light
- Selector Wires



Selector wires (violet) not connected.
Maximum LED forward voltage 250 VDC max
Nominal output current 100 mA.



Selector wires (violet) connected.
Maximum LED forward voltage 100 VDC max
Nominal output current 250 mA.



Pilot Light

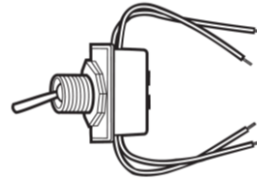

Test Switch

KEY OPTIONS

- Remote Test Switch ELA RTS2

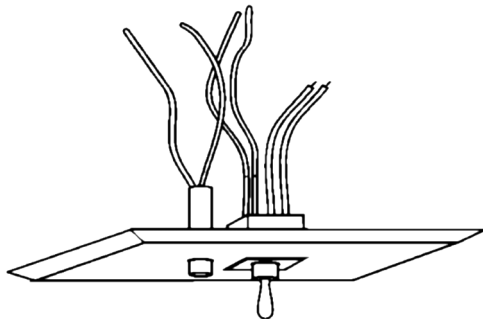

ELA RTS2