

DESCRIPTION

The EI2700AT housing is designed for use in shallow ceilings where 2" x 6" joist construction is used. The wide variety of trims available allows a number of different lighting effects to be created with one basic housing.

APPLICATION

The EI2700AT is designed for shallow ceilings where insulation is present. The EI2700AT housing is AIR-TITE construction and meets restricted airflow requirements.

DESIGN FEATURES

A...Housing

Aluminum housing for greater heat dissipation.

B...Socket Plate

Fixed socket plate for consistent lamp position

C...Plaster Frame

Housing adjusts in plaster frame 1 3/8" to accommodate different ceiling thicknesses.

D...Junction Box

U.L. listed for through branch circuit wiring. Positioned to accommodate straight conduit runs. Seven conduit knockouts are uniform 1/2" size with true pryout slots. Four Romex pryouts with integral strain relief also included.

E...Bar Hangers

Pre-installed, captive bar

hangers allow housing to be positioned at any point within a 24" joist span. Score lines provided for easy field shortening for 12" joists. Unique arrowhead design provides "nailess" installation. Bar hangers can be repositioned 90° without tools on plaster frame. Bar hangers can be locked in position with lock down screw and/or crimping tabs.

F...Socket

Porcelain socket with nickel plated brass screw shell.

G...Thermal Protector

Integral Thermal Protector deactivates fixture if an incorrect lamp is used or if ceiling insulation material is not applied correctly.

Labels

- UL Listed for Damp Location
- UL listed for Feed Through
- UL listed for Direct Contact with Insulation and combustible material
- CSA Certified

Meets following requirements:

- State of California Title 24
- Washington State Energy Code
- International Energy Conservation Code (IECC)
- New York State Energy Conservation Construction Code (NY-ECCC)
- Model Energy Code (MEC)
- Certified Under ASTM-E283



EI2700AT

6" Insulated Ceiling Recessed Housing

6" TRIMS

FOR USE IN INSULATED CEILINGS

FOR USE IN SHALLOW CEILINGS

airtite™

with all trims listed

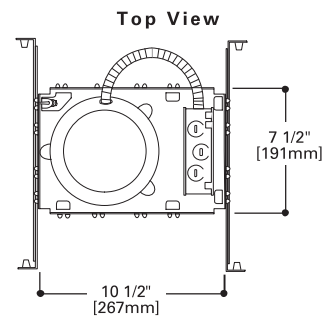
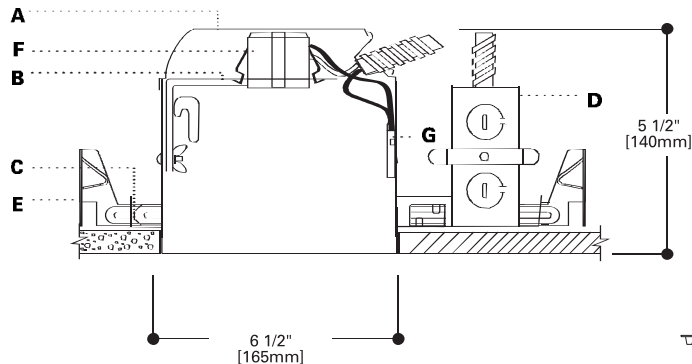

Ordering Information on reverse.

TRIMS

ORDERING INFORMATION

SAMPLE NUMBER: EI2700ATERT710

Order housing and trim separately.

Housing

EI2700AT= IC AIR-TITE™
Housing

Trims

REFLECTORS



ERT710

Cone Reflector
75W R30, 50W PAR30, 75W PAR30L, 65W BR30
ERT710=Specular Clear Reflector,
High Gloss Appliance White Trim Ring
ERT710G=Gold Reflector, White Trim
Ring

OD: 8" (203mm)

BAFFLES



ERT707

Metal Baffle
65W BR30, 50W PAR30, 75W PAR30L
ERT707=Black Baffle, High Gloss Appliance White
Trim Ring
ERT707WHT=White Baffle, High Gloss Appliance
White

OD: 8" (203mm)

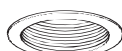

ERT714

Plastic Baffle
50W PAR30, 75W PAR30L, 65W BR30
ERT714=Black Baffle
High Gloss Appliance White Trim Ring
ERT714WHT=White Baffle
High Gloss Appliance White Trim Ring

OD: 8" (203mm)

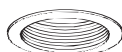

ERT716

Full cone Shallow White Metal Baffle
65W BR30, 75W PAR30, 75W PAR30L
ERT716WHT=Full Cone Shallow Metal Baffle
High Gloss Appliance White Finish

OD: 8" (203mm)



ERT705

Open
50W PAR30L, 75W R30
ERT705=High Gloss Appliance White Open Trim

OD: 7 1/4" (184mm)

ADJUSTABLES



ERT704

Eyeball
75W R30, 75W PAR30L, 65W BR30
ERT704=High Gloss Appliance White Eyeball
ERT704PB=Polished Brass Eyeball

OD: 8" (203mm)



ERT711

Regressed Eyeball
50W PAR30
ERT711=High Gloss Appliance White Eyeball Black
Baffle

OD: 8" (203mm)

SHOWERLIGHT



ERT721

Albalite Lens Shower Light
35W PAR30L
ERT721=Shower Light,
High Gloss Appliance White Trim Ring

OD: 8" (203mm)

Note: Specifications and Dimensions subject to change without notice.

Visit our web site at www.cooperlighting.com